

# THE SOLUTION WORK STATION FUME HOOD

APPLICATIONS: HIGHER EDUCATION; INDUSTRIAL; RESEARCH

**SPECIFY FITTINGS/ FIXTURES REQUIRED:**

ALARM 500

ALARM 1000

OTHER ALARM / VAV (CUTOUT ONLY)

BLOWER SWITCH (OPTIONAL)

SERVICE

SERVICE

SERVICE

SERVICE

120V GFI DUPLEX (OPTIONAL)

**SPECIFY FITTINGS/ FIXTURES REQUIRED:**

ALARM 500

ALARM 1000

OTHER ALARM / VAV (CUTOUT ONLY)

LIGHT SWITCH (OPTIONAL)

SERVICE

SERVICE

SERVICE

SERVICE

120V GFI DUPLEX (OPTIONAL)

**CUSTOMER LOGO**

**PRE-PIPING:**

YES  NO

PRE-PIPING UP

PRE-PIPING DOWN

**BASE CABINET OPTIONS:**

ACID CABINET	___"W x ___"H x ___"D
FLAMMABLE CABINET	___"W x ___"H x ___"D
VACUUM PUMP CABINET	___"W x ___"H x ___"D
HOOD BASE FRAME	___"W x ___"H x ___"D
SINK BASE CABINET	___"W x ___"H x ___"D

**CORROSIVE CAUTION**

**FLAMMABLE KEEP FIRE AWAY**

**CABINET PULL OPTIONS:**

BRUSHED ALUMINUM BAR STYLE

BRUSHED STEEL WIRE STYLE

BRUSHED ALUMINUM RECESS STYLE

BLACK RECESS STYLE

STAINLESS STEEL WIRE STYLE

**LENGTH**

48"  60"  72"  96"

Custom sizes available ; Contact AMS

**SPECIAL REQUIREMENTS:** \_\_\_\_\_

\_\_\_\_\_

\_\_\_\_\_

**WIRING DIAGRAM**

**WIRING DIAGRAM REQUIRED**

**WORK SURFACE MATERIAL:**

BLACK EPOXY (standard)  
Other Color: \_\_\_\_\_

TYPE 304 STAINLESS STEEL

TYPE 316 STAINLESS STEEL

**CUSTOMER:** \_\_\_\_\_

**QTY:** \_\_\_\_\_

**COLOR:** \_\_\_\_\_

**INTERIOR Baffle Arrangement:**  
Fixed Baffles (standard)

• **Exhaust Collar:**  
Type 304 s/s - 10" Dia. Round (standard)  
Other \_\_\_\_\_

• **Interior Lighting Fixture:**  
Standard LED Fixtures (standard)

• **Sash Frame & Glass:**  
Painted Steel Frame w/ Laminated Safety Glass (standard)

• **Airfoil:**  
Painted Steel (standard)

• **Sash Type:**  
Vertical (standard)

• **Pre-Piping / Pre-Wiring:**  
All hoods are pre-wired & pre-piped unless otherwise noted.

• **Sash Drive:**  
Chain & Sprocket Sash Drive (standard)

• **Sight Line:**  
36-inch high viewing sightline (standard)

**OPTIONAL ACCESSORIES**

**Lattice Assembly:**

NONE

Aluminum Lattice Assembly

Stainless Steel Assembly

**Interior Lighting Fixture:**

Explosion Proof Light

**Fume Hood Alarm Option:**

Alarm Tel AFA\_500

Alarm Tel AFA\_1000

Alarm / AVA Cutout (Customer **MUST** provides cutout detail)

**Sash Full-Length Finger Lift:**

Type 304 Stainless Steel

Type 316 Stainless Steel

**Airfoil:**

Type 304 Stainless Steel

Type 316 Stainless Steel

**Trough:**

NONE (Standard)

Painted Steel

Type 304 Stainless Steel

Type 316 Stainless Steel

**Ceiling Enclosure:**

Yes (Height: \_\_\_\_\_)  No

• **Hinged Access Panel on Ceiling Enclosures?:**

Yes  No

**Sash Type:**

Combination

Horizontal

**Additional Options:**

Blower  Electronic Sash Closer

Sash Alarm

Push Button Sash Stop

Automatic Sash Return

**Pass Through Cord Ports**

1.5" Dia. Front Post Cord Ports

\_\_\_\_\_ Dia. Side Panel Cord Ports (please specify size)

**Service Fixture Type:**

Ball valve w/ lever handles (ADA)

Front Mount Valve w/ four-arm handle (Standard)

Special Plumbing Requirements: \_\_\_\_\_

**AIR MASTER SYSTEMS CORP**  
6480 NORTON CENTER DR.  
MUSKEGON, MI 49441  
TEL: (231) 798-1111 FAX: (231) 798-4000

# THE SOLUTION WORK STATION FUME HOOD

APPLICATIONS: HIGHER EDUCATION; INDUSTRIAL; RESEARCH

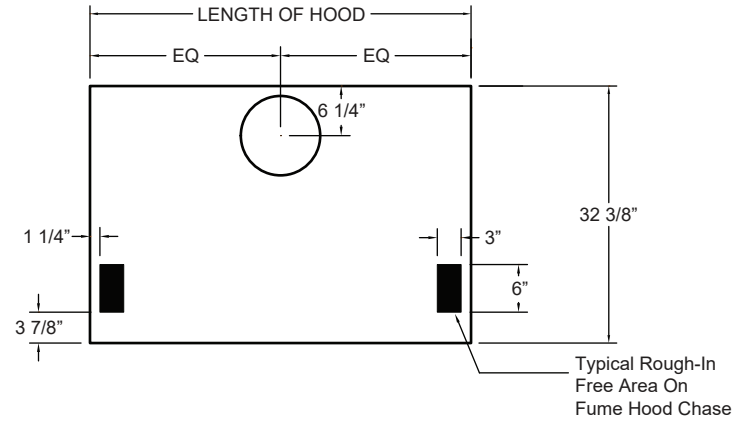

**SERVICE ROUGH-IN DETAIL**  
(FOR 48", 60", 72", & 96" HOODS)

**EPOXY WORK SURFACE**  
(SPECIFY LOCATION OF CUPSINK)

**CUPSINK OPTIONS:**

- 3" x 6"
- 3" x 9"
- OTHER \_\_\_\_\_
- NONE
- ADD 0.25" RAISED RIM

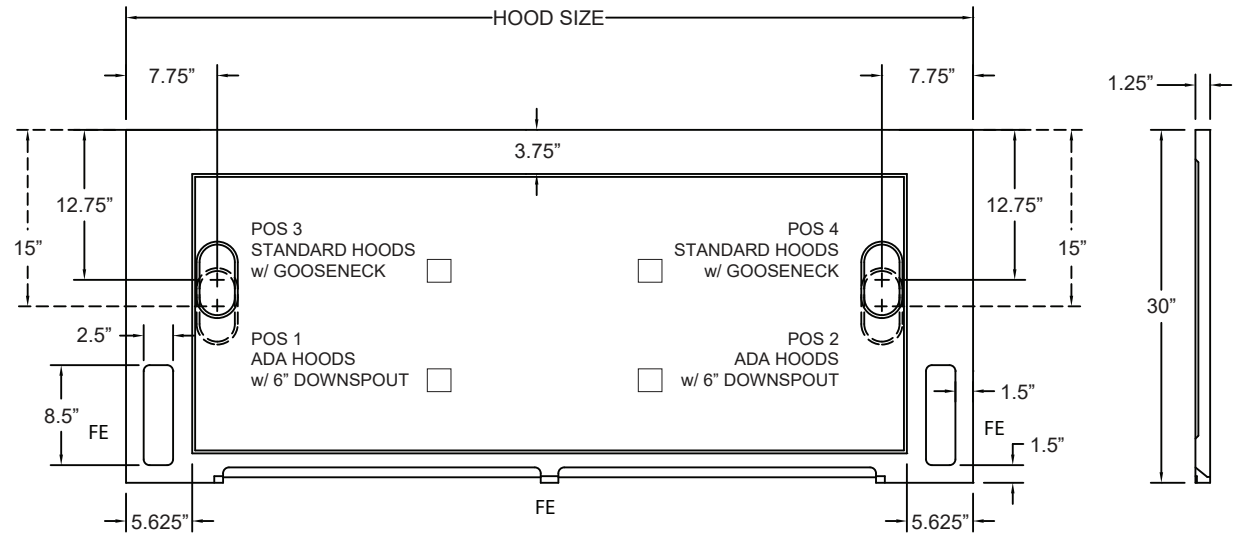

PART #	SUPERSTRUCTURE			18" SASH HT.			28" SASH HT.			
				CFM @100 FPM	CFM @60 FPM	SP	HOOD OPENING (SQ. FT)	CFM @100 FPM	CFM @60 FPM	SP
	W	H	D							
SWS-48	48"	69.375"	34"	475	285	.09	7.29	770	433	.24
SWS-60	60"	69.375"	34"	625	375	.11	9.63	1000	583	.30
SWS-72	72"	69.375"	34"	775	465	.15	11.96	1250	723	.39
SWS-96	96"	69.375"	34"	1075	645	.10	16.63	1730	1003	.27