

THE SOLUTION WORK STATION FUME HOOD

APPLICATIONS: RESEARCH & PRIVATE RESEARCH

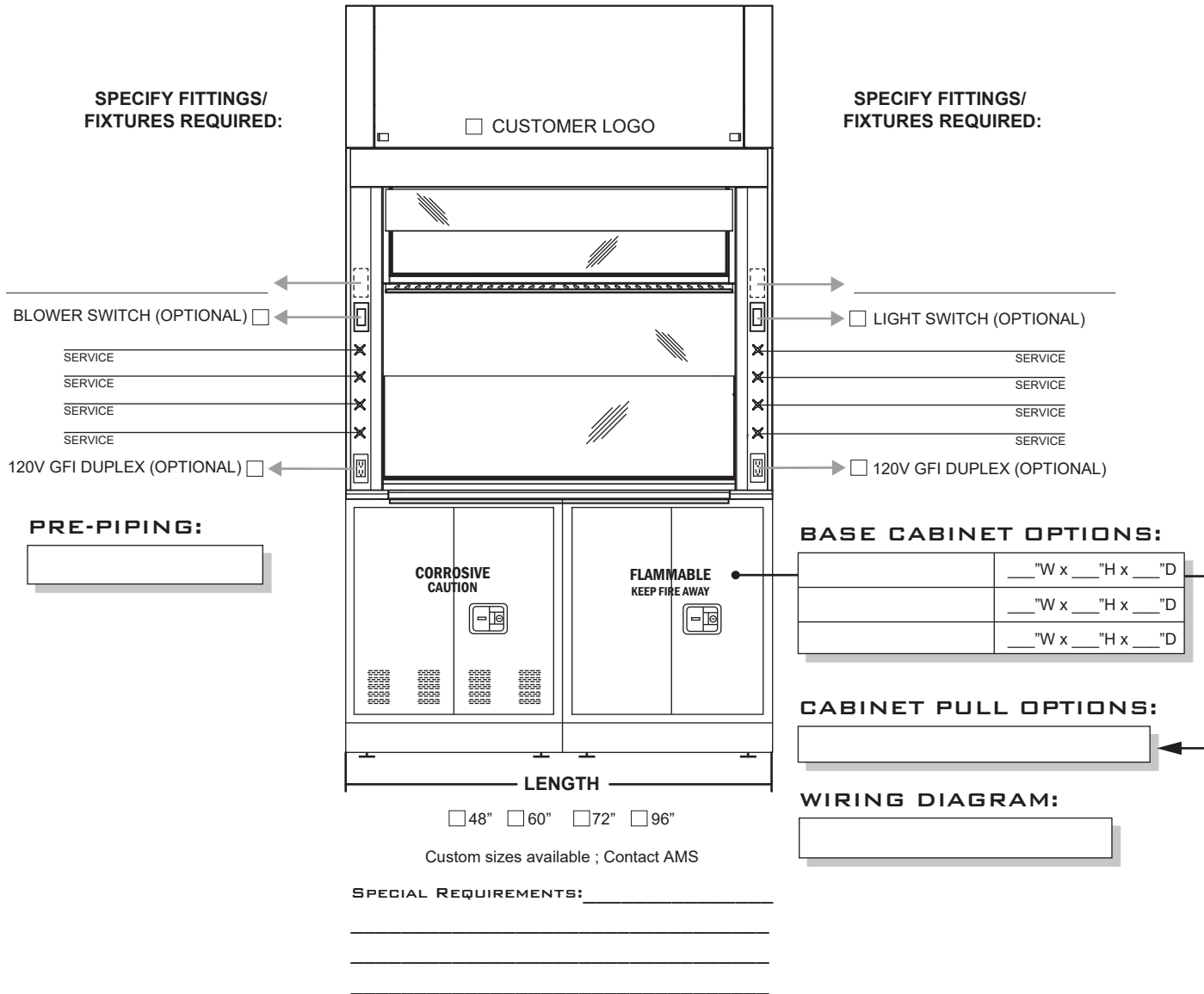

STANDARD FEATURES

- **Interior Baffle Arrangement:**
Fixed Baffles (standard)
- **Exhaust Collar:**
Type 304 s/s - 10" Dia. Round (standard)
Other _____
- **Interior Lighting Fixture:**
Standard LED Fixtures (standard)
- **Sash Frame & Glass:**
Painted Steel Frame w/ Laminated Safety Glass (standard)
- **Airfoil:**
Painted Steel (standard)
- **Sash Type:**
Vertical (standard)
- **Pre-Piping / Pre-Wiring:**
All hoods are pre-wired & pre-piped unless otherwise noted.
- **Sash Drive:**
Chain & Sprocket Sash Drive (standard)
- **Sight Line:**
36-inch high viewing sightline (standard)

OPTIONAL ACCESSORIES

- Lattice Assembly:**
- _____
- Interior Lighting Fixture:**
- Explosion Proof Light
- Airfoil:**
- _____
- Trough:**
- _____
- Ceiling Enclosure:**
- Yes (Height: _____) No
- **Hinged Access Panel on Ceiling Enclosures?:**
- Yes No
- Finished Back:**
- Yes No
- Sash Type:**
- _____
- Sash Full-Length Finger Lift:**
- _____
- Additional Options:**
- Blower Electronic Sash Closer
- Sash Alarm
- Push Button Sash Stop
- Automatic Sash Return
- Pass Through Cord Ports**
- 1.5" Dia. Front Post Cord Ports
- _____ Dia. Side Panel Cord Ports (please specify size)
- Service Fixture Type:**
- _____
- Pre-Wire + Electrical:**
- Yes No



AIR MASTER SYSTEMS CORP
6480 NORTON CENTER DR.
MUSKEGON, MI 49441
TEL: (231) 798-1111 FAX: (231) 798-4000

CUSTOMER: _____
QTY: _____
COLOR: _____

THE SOLUTION WORK STATION FUME HOOD

APPLICATIONS: RESEARCH & PRIVATE RESEARCH

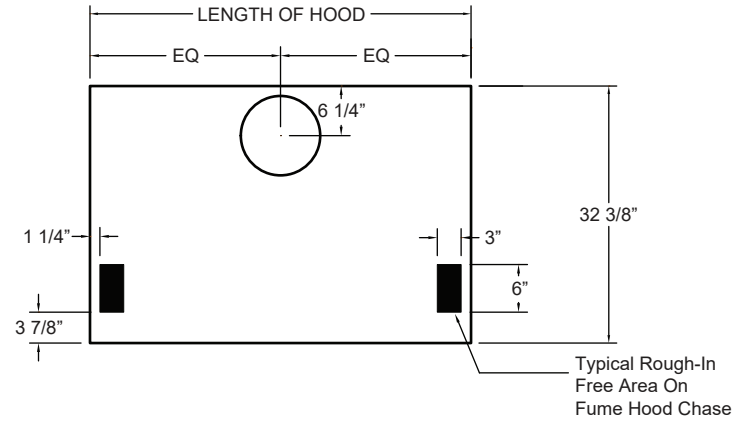

SERVICE ROUGH-IN DETAIL
(FOR 48", 60", 72", & 96" HOODS)

EPOXY WORK SURFACE
(SPECIFY LOCATION OF CUPSINK)

CUPSINK OPTIONS:

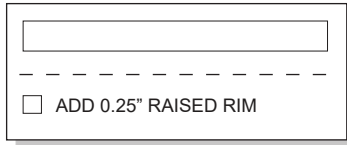

WORK SURFACE MATERIAL:

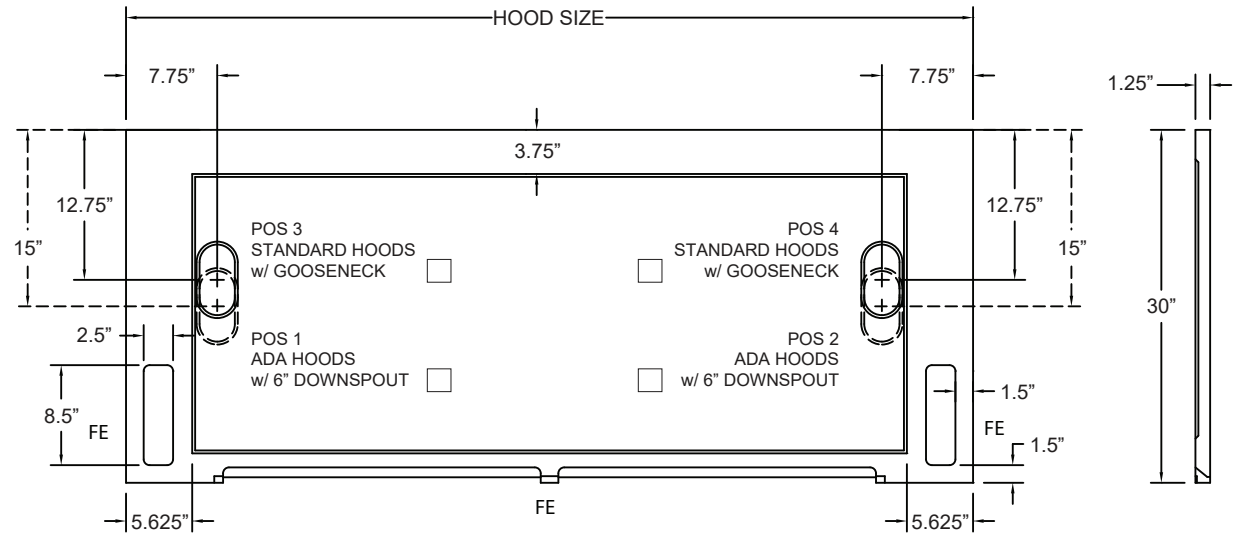

PART #	SUPERSTRUCTURE			18" SASH HT.			28" SASH HT.			
				CFM @ 100 FPM	CFM @ 60 FPM	SP	HOOD OPENING (SQ. FT)	CFM @ 100 FPM	CFM @ 60 FPM	SP
	W	H	D							
SWS-48	48"	69.375"	34"	475	285	.09	7.29	770	433	.24
SWS-60	60"	69.375"	34"	625	375	.11	9.63	1000	583	.30
SWS-72	72"	69.375"	34"	775	465	.15	11.96	1250	723	.39
SWS-96	96"	69.375"	34"	1075	645	.10	16.63	1730	1003	.27