

Adjustable Gemini Work Bench

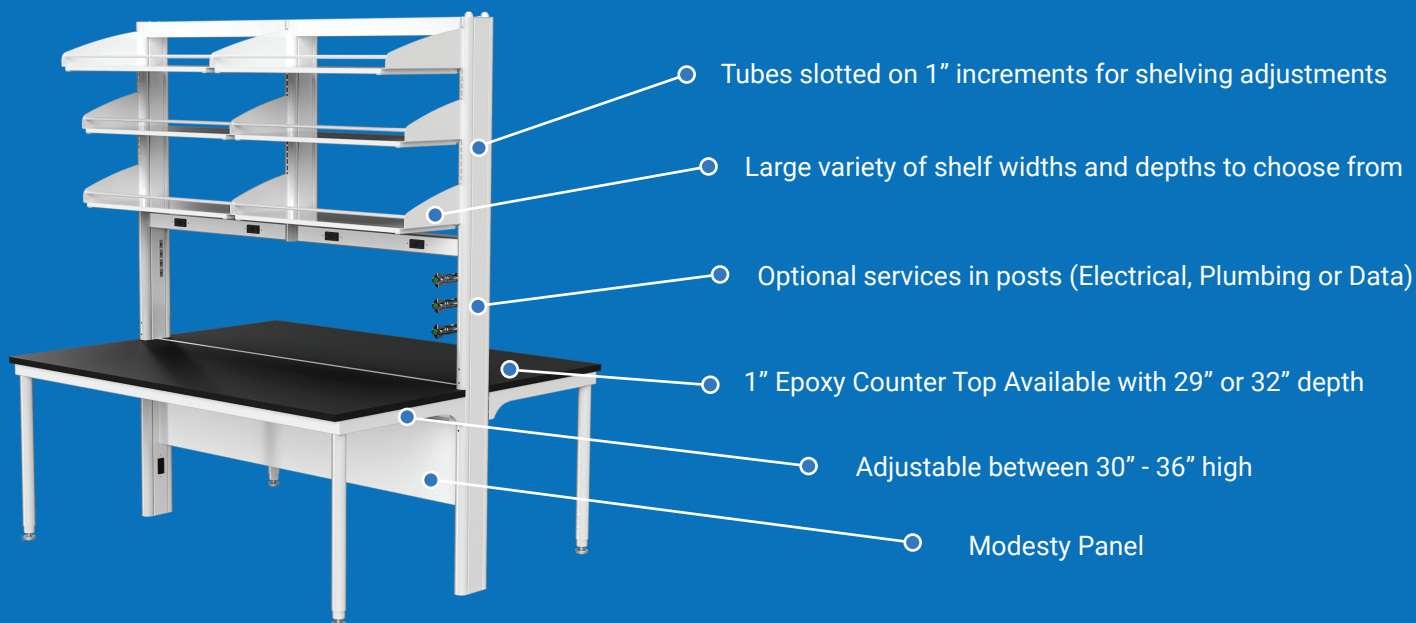

Flexible work bench for numerous lab setups & applications

AMS offers the Gemini Laboratory Bench System to fit the design of most laboratory configurations. With plumbing, electrical and data services pre-wired and pre-plumbed at the factory, installation time is greatly reduced over conventional casework. Renovating the lab to a different layout is just as easy. Connect the services to a ceiling service panel or overhead carrier and you are up and running. Gemini is available in single or double-sided configurations from 36" - 96" wide to fit your space, allowing for multiple depth choices. Units can be ordered in a multitude of configurations. The maximum customizable electrical services are based on width of the Gemini bench. Split and full-width shelving is available in bookend, seismic rod, or inverted. Depths of shelving are also customizable.

Width	No Services	w/ Services*	Double-Sided	Double-Sided w/ Services*
36"	GS1-3630-E	GS1-3630-_P-_D-_E-E	GS2-3630-E	GS2-3630-_P-_D-_E-E
42"	GS1-4230-E	GS1-4230-_P-_D-_E-E	GS2-4230-E	GS2-4230-_P-_D-_E-E
48"	GS1-4830-E	GS1-4830-_P-_D-_E-E	GS2-4830-E	GS2-4830-_P-_D-_E-E
60"	GS1-6030-E	GS1-6030-_P-_D-_E-E	GS2-6030-E	GS2-6030-_P-_D-_E-E
72"	GS1-7230-E	GS1-7230-_P-_D-_E-E	GS2-7230-E	GS2-7230-_P-_D-_E-E
84"	GS1-8430-E	GS1-8430-_P-_D-_E-E	GS2-8430-E	GS2-8430-_P-_D-_E-E
96"	GS1-9630-E	GS1-9630-_P-_D-_E-E	GS2-9630-E	GS2-9630-_P-_D-_E-E

*Part number used as example. Part numbers marked with _ will change dependent upon customization. Reference choice sheet or Solution Catalog for full list of suffixes.

** -E refers to Epoxy Top. Does not come standard with bench.

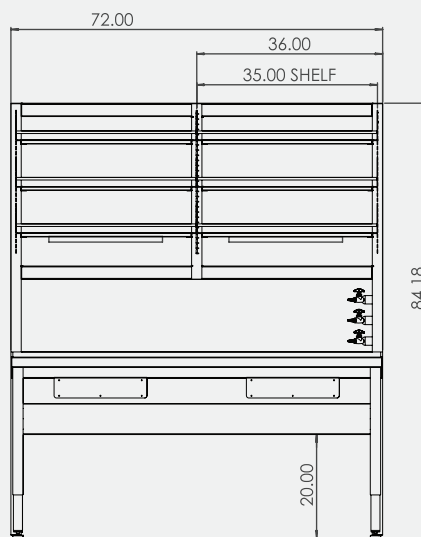
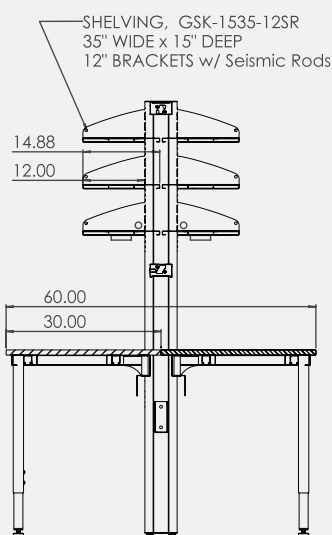

*Plumbing fixtures & Shelving shown for example only.
Does not come standard with base Gemini bench.

